

Steel Base Dial Indicator Stands & Comparator Stands

Jafuji Dial Indicator Stands and Comparator Stands are of robust design and have accurate ground working surfaces. Rapid Adjustment of the Dial Indicator is possible by moving it along the vertical columns which facilitates measurements at any point over the table.

Mini Dial Indicator Stand (Carbide Anvil)

Code No. - 1000

Indigenously designed and developed for special applications.

Clamping Stem Diameter : 8 mm
Maximum Working Height : 100 mm
Mass Kg. : 2.8

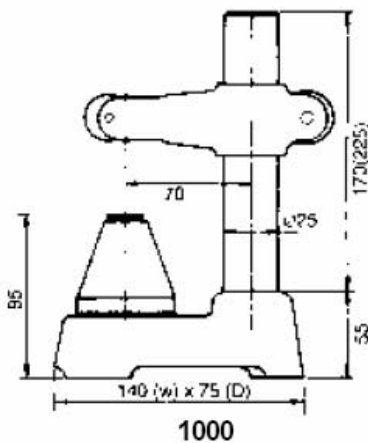
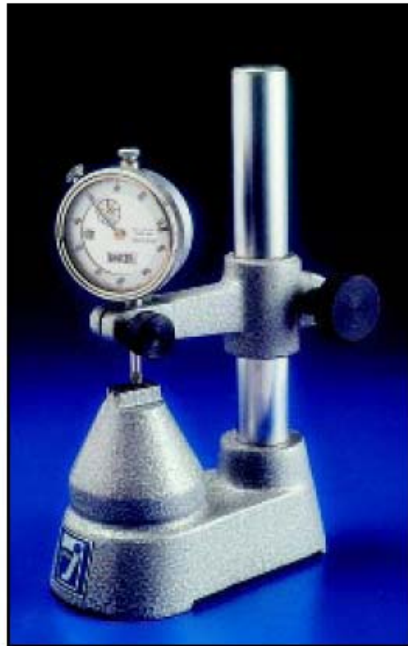

Mini Dial Indicator Stand Code No. - 1010

Particularly suitable for quick and accurate inspection of small flat or round works. It is also readily adaptable as a thickness gauge.

Clamping Stem Diameter : 8 mm
Maximum Working Height : 100 mm
Mass Kg. : 2.8

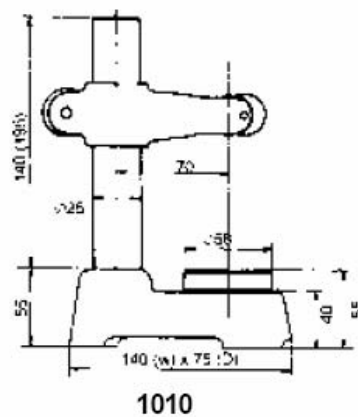

Upright Dial gauge Stand -Code No. 1040

This Dial Gauge Stand is Compact and inexpensive. Suitable for inspecting small parts on the shop floor.

Anvil Diameter : 40 mm
Maximum working Height : 20 mm
Mass Kg. : 1.5
Remarks : Lug-On-Centre Back Centre clamp

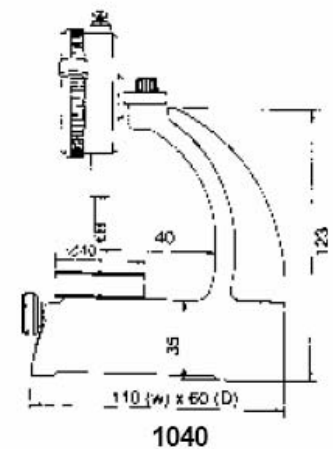

Dial Indicator Stands

Jafuji Dial Indicator Stands and Comparator Stands are extremely rugged and universally adjustable to any position. These gauges are well suited to inspection, layout, checking and lineup operations anywhere in the shop. All settings are individually made without disturbing others. Quick height positioning of the indicator as well as adjustment in a horizontal plane is accomplished by a bracket holding the 22 mm horizontal gauge rod. Individual knurled thumb knobs clamps on the base post in any position. The horizontal gauge rod provides length wise adjustment and each movement is having its own clamping knob. The grid type accurately ground anvil prevents work piece from sticking to it.

Maxi Dial Indicator Stand -Code No. -1020

Robust design having an accurately ground working surface. Rapid adjustment of the dial indicator is possible by moving it along the ground horizontal and vertical columns, which facilitates measurements at any point over the table.

Clamping stem diameter : 8 mm
Maximum working height : 150 mm
Mass Kg. : 7.8

Large Maxi Dial Indicator Stand -Code No. -1030

This has similar features of Maxi Dial Indicator Stand, provided with large measuring table.

Clamping stem diameter : 8 mm
Maximum working height : 300 mm
Mass Kg. : 14

Watch Maker's Mini Dial Indicator Stand -Code No. -1060

Clamping stem diameter : 8mm
Maximum working height : 50mm
Fine adjusting range : 50mm
Mass Kg. : 6

Similar to 1070 with Anvil height fine adjustment of 50mm

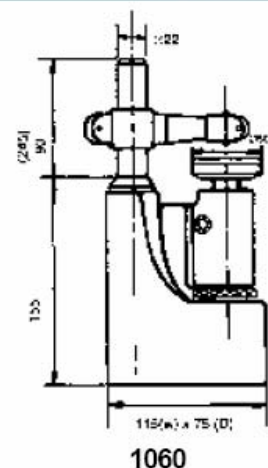
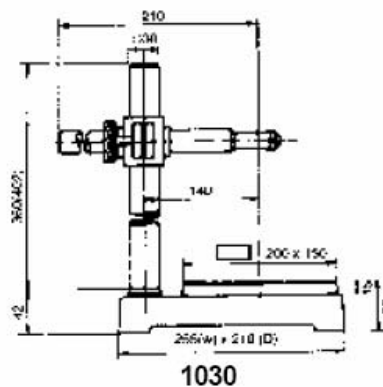
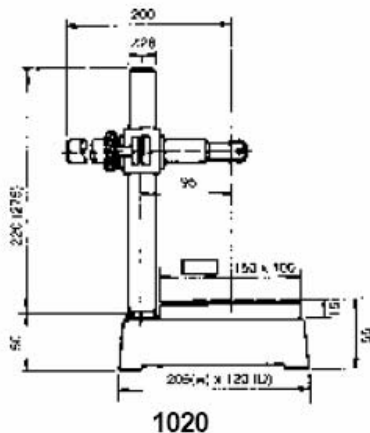
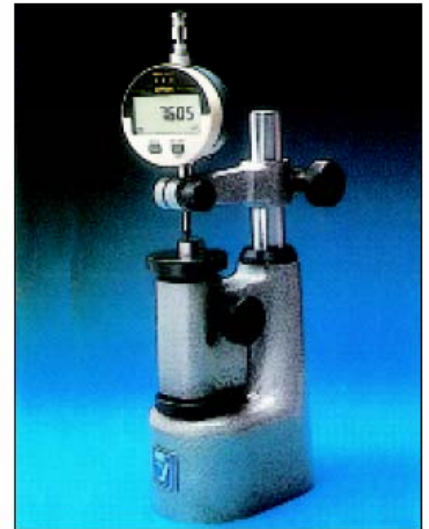

Dial Gauge Stands, Transfer Stands

These dial Gauge Stands and Transfer Stands consists of a very stable, cast iron base and an upright column with a mounting bracket that features fine adjustment. The serrated anvil prevents the work piece from sticking to it.

This rugged transfer stand provides a rigid, stable base with complete and constant accuracy. It is an Unique stand for sensitive dial test indicators to accurately transfer height settings from standard gauges and gauge blocks.

Dial Gauge Stand

-Code No. 1100 & 1110
(Similar to Mitutoyo 7001, 7002)

This is a very versatile stand. It easily adapts to thickness gauges and COMPARATOR work. It is compact and has sturdy cast iron base. The rugged bracket holds Dial Indicator firmly in place. It can also mount DIGIMATIC Indicator and Linear gauges with fine adjustment range of 1mm for zero settings. Optional interchangeable anvils are also available.

For Code No. 1100 -1110 :

Clamping stem diameter : 8mm
Maximum working height : 125mm
Fine adjusting range : 1mm
Mass Kg : 4.25



Dial Gauge Stand

-Code No. 1120, 1130
(Similar to Mitutoyo 519-109)

This has unique construction element vibration when the stand is moved across the surface plate. To ensure accuracy, the stand rest on three ground pads. The sturdily constructed base and column allows complete rigidity when measuring. Fine adjusting range of 1mm for zero settings.

For Code No. 1120 :

Clamping stem diameter : 8mm
Maximum working height : 300mm
Fine adjusting range : 1mm
Mass Kg : 5

For Code No. 1130

Clamping stem diameter : 8mm
Maximum working height : 600mm
Fine adjusting range : 1mm
Mass Kg : 5.80

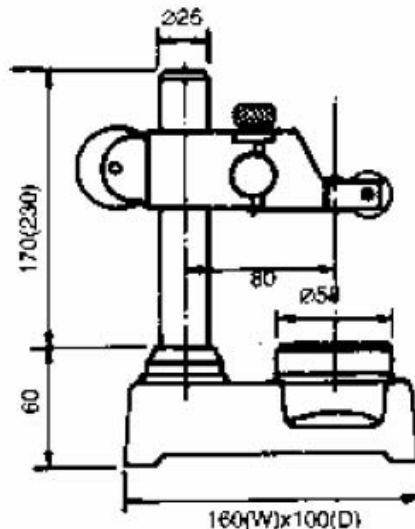

1100 & 1110

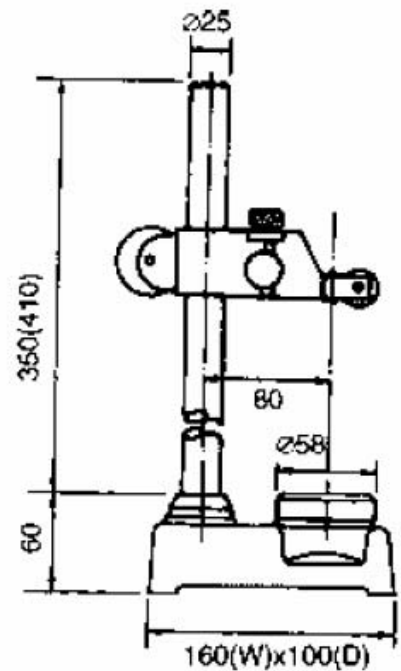

1120 & 1130

Watch Maker's Mini Dial Indicator Stand

-Code No. :1070

The ideal dial gauge stand for checking small components for rapid inspection settings of small components, anvil is provided with fine adjustment by means of knurled thumb nut from bottom.

Clamping stem diameter : 8 mm
 Maximum working height : 50 mm
 Fine adjusting range : 50 mm
 Mass Kg. : 2.4

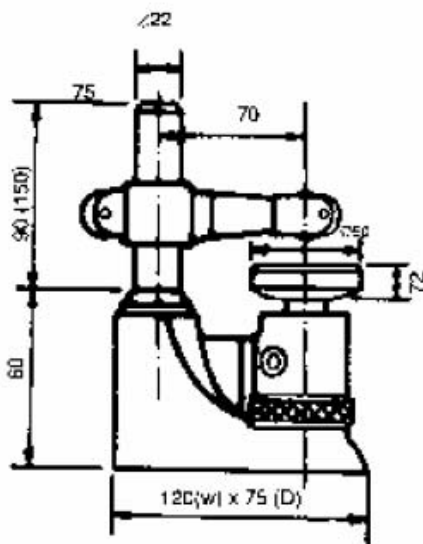

1070

Mykrokator Stand (CEJ Type)

- Code No. :1080

Ideally suitable and sturdy stand for Precision Mykrokator Indicator. Anvil is provided with fine adjustment knurled thumb nut from bottom. Dial indicator bracket is provided with easy fine adjustment from the top of upright post.

Clamping stem diameter : 28 mm/8 mm
 Maximum working height : 180 mm
 Fine adjusting range : 10 mm
 Mass Kg. : 11

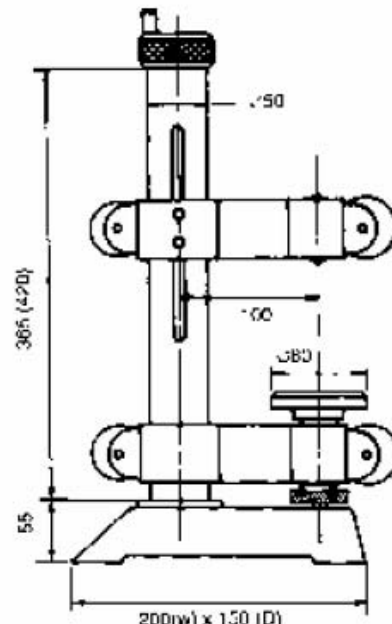

1080

Mykrokator Stand

- Code No. :1090

Fine adjustment screws at the bottom to adjust the height of the anvil. Shank Dial 8mm or 28mm interchangeable

Clamping stem diameter : 28 mm/8 mm
 Maximum working height : 100mm
 Fine adjusting range : 5mm
 Mass Kg. : 6

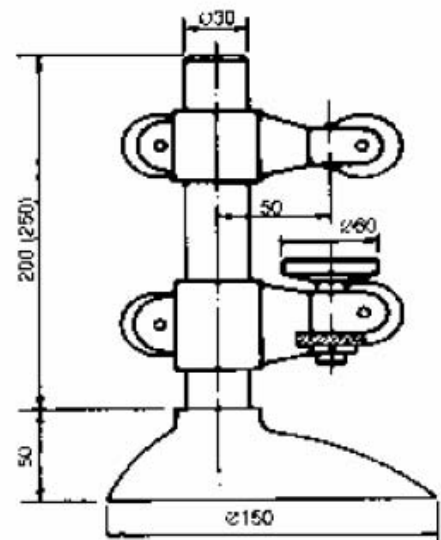

1090

Dial Comparator Stand

-Code No. 1140

90mm Sq. ANVIL (Similar to Mitutoyo 7007)

This dial gauge stand and Comparator Stand consists of a very stable, cast iron base and an upright column with a mounting bracket that features fine adjustment. The grid type anvil prevents the work piece from sticking to it.

Clamping stem diameter : 8mm
Maximum working height : 100mm
Fine adjusting range : 1mm
Mass Kg : 4

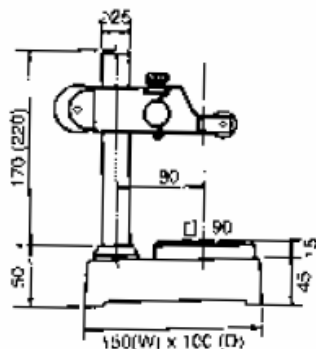

1140

Dial Comparator Stand

-Code No. 1150

110 mm Sq. ANVIL (Similar to Mitutoyo 215-402, 215-403)

This dial gauge stands and Comparator Stand consists of a very stable, cast iron base, with fine adjustment which consists of a strong and rigid parallel spring assembly.

Clamping stem diameter : 8 mm
Maximum working height : 180 mm
Fine adjusting range : 1mm
Mass Kg : 8

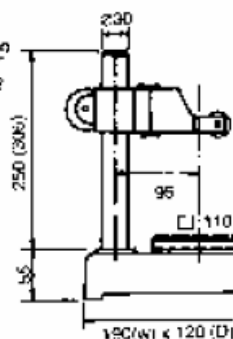

1150

Dial Comparator Stand

-Code No. 1160 & 1170

(Similar to Mitutoyo 215-501, 215-502)

These heavy-duty precision dial gauge stand is provided with rapid fine adjustment movement. The serrated column has a knurled thumb nut which permits rapid up and down movement of indicator bracket assembly that acts as a safety device preventing accidental dropping of the Indicator bracket Assembly. The final indicator setting is made by turning a fine adjusting knob on the indicator bracket.

For Code No. 1160

Clamping stem diameter : 8mm (12mm)*
Maximum working height : 260mm
Fine adjusting range : Entire Stroke
Mass Kg : 14.5

* When using a bushing (Standard accessory)

For Code No. 1170

Clamping stem diameter : 8mm
Maximum working height : 260mm
Fine adjusting range : 1mm
Mass Kg : 14.5

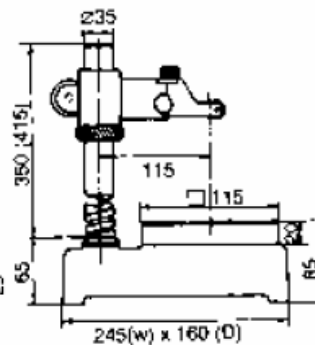

1160/1170

Bore Measuring Stand

- Code No. 1310

For the quick checking of bores in small work pieces. Hardened anvil plate can be raised with the lever, thus moving test piece into position. The anvil can be clamped at any height for checking eccentricity.

Clamping stem diameter : 15 mm

Mass Kg : 6

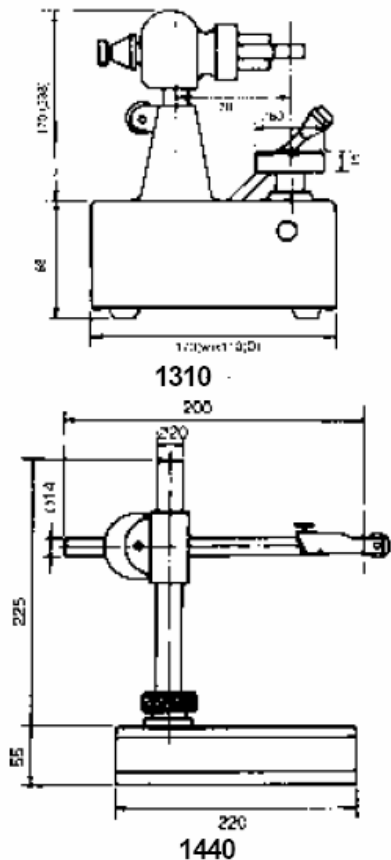

Universal Dial Indicator Stand

- Code No. 1440

This extra heavy and rugged Universal Testing Stand with fine adjustment makes quick and accurate measurement possible on surface plate setups. It is most useful for testing spindle run out of machine tools, lathe work etc., where the highest accuracy is required. The indicator can be swivelled in all directions. It can be used in many different ways, e. g. on the surface plate in testing parallel surface of work piece. On machine tools for setting up pieces to be machined, with reference to already existing surface. It can be also be used with Bench Centre.

Clamping stem diameter : 8 mm

Maximum working height : 250 mm

Fine adjusting range : 1 mm

Mass Kg : 5



Universal Dial Indicator Stand (Light duty with bottom Vee)

- Code No. 1450

This is the most versatile and universal testing stand. It's added feature is provided with "Vee" on bottom surface of the base to facilitate inspection over cylindrical surfaces.

Clamping stem diameter : 8 mm

Maximum working height : 240 mm

Fine adjusting range : 1mm

Mass Kg : 5.25

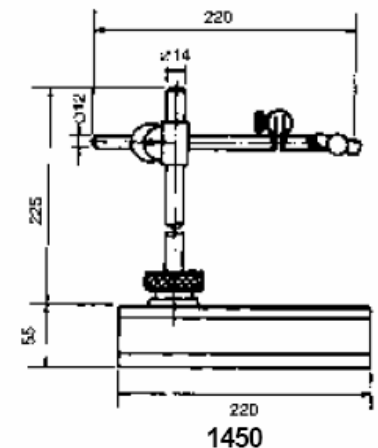

Dial Indicator Stand

-Code No. 1180

The dial Gauge Stand is provided with serrated square anvil. The serrated column has a knurled thumb nut which permits rapid up and down movement of the indicator fine adjustment bracket assembly.

Clamping stem diameter : 8mm
Maximum working height : 200mm
Fine adjusting range : 1mm
Mass Kg : 6

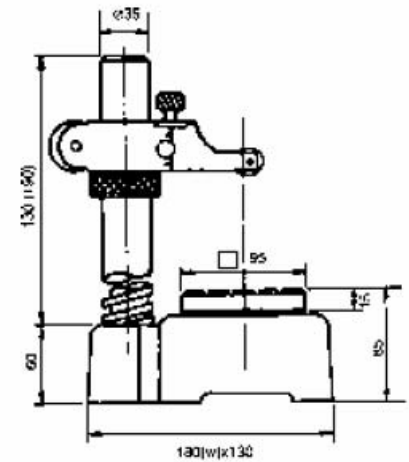

1180

Dial Comparator Stand

-Code No. 1190

This Dial Gauge Comparator Stand base is made from closed grained cast iron castings, seasoned, stress relieved and accurately ground working surfaces. With fine adjusting range of 1mm.

Clamping stem diameter : 8mm
Maximum working height : 130mm
Fine adjusting range : 1mm
Mass Kg : 8

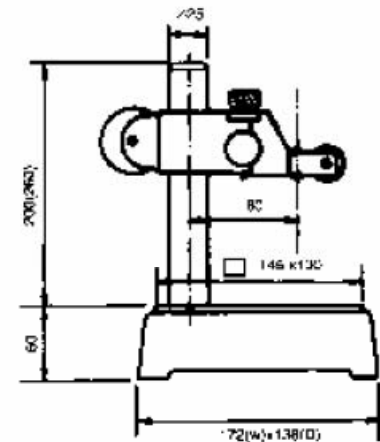

1190

Micrometer Stand

- Code No. 1660 /1670

Finely finished Micrometer Stand can be adjusted to any position.

The Micrometer Stand has a necessary clamping device, which is meant for usage, when more precise measurements are required. Provides a desirable measuring position and angle for inside and outside Micrometers and many other instruments.



and Comparator Stands

JAFUJI Granite Comparator Stands are made from rigid granite base which is free from burrs, pile ups, rust and deterioration over time. These stands satisfy all types of precision measuring assignments, including comparative measurement.

Dial Gauge Stand

- Code No. 1210

Light duty granite Dial gauge stand. Horizontal arm is provided with fine adjustment. The Horizontal arm built in with fine adjustment for easy Dial Indicator zero setting.

Clamping stem diameter : 8 mm
 Maximum working height : 180 mm
 Fine adjusting range : ENTIRE STROKE
 Mass Kg : 7

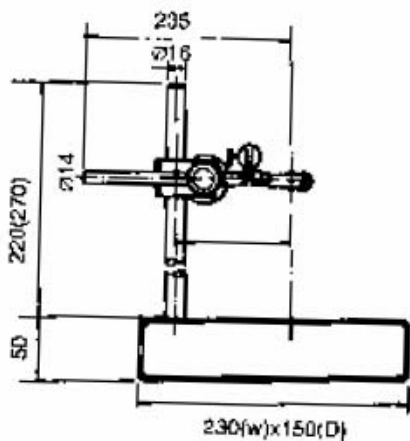

1210

Dial Gauge Stand with F/A

- Code No. 1230

The serrated column has a knurled thumb nut which permits rapid up and down movement of indicator bracket assembly and acts as a safety device, preventing accidental dropping of the indicator bracket assembly. Fine indicator setting is made by turning a fine adjustment knob on the indicator bracket.

Clamping stem diameter : 8 mm
 Maximum working height : 200 mm
 Fine adjusting range : 1mm
 Mass Kg : 10

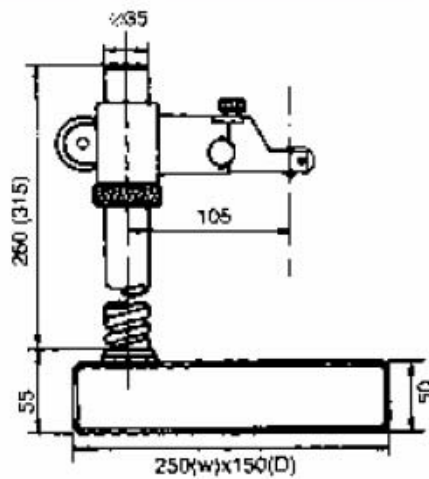

1230

Bench Dial Comparator Stand

- Code No. 1260

This Bench Type Dial Comparator Stand is meant for larger diameter components and has got a serrated column with knurled thumb nut with fine adjustment dial indicator holding bracket assembly.

Clamping stem diameter : 8mm
 Maximum working height : 200mm
 Fine adjusting range : 1mm
 Mass Kg : 35

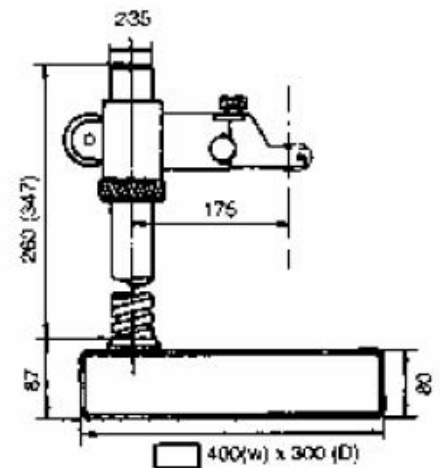
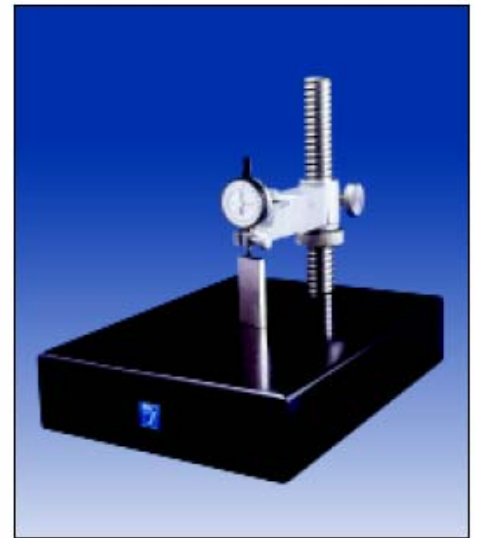

1260

Maxi Dial Indicator Stand

- Code No. 1220

This Granite Base Dial Indicator Stand has a Black Granite base. Vertical Column and Horizontal arm provides Maximum rigidity and convenience of measurement for the entire indicator assembly.

Clamping stem diameter : 8 mm

Maxi working height : 150 mm

Fine adjusting range : ENTIRE STROKE

Mass Kg : 8

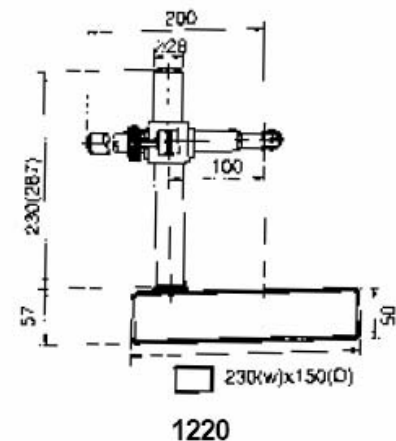

Large Maxi Dial Indicator Stand

- Code No. 1240 & 1250

Large Maxi-Dial Comparator Stands are ruggedly built for inprocess and final inspection work of large components. They are provided in two different base sizes.

For code No. 1240

Clamping stem diameter : 8 mm

Maxi working height : 300 mm

Fine adjusting range : ENTIRE STROKE

Mass Kg : 14

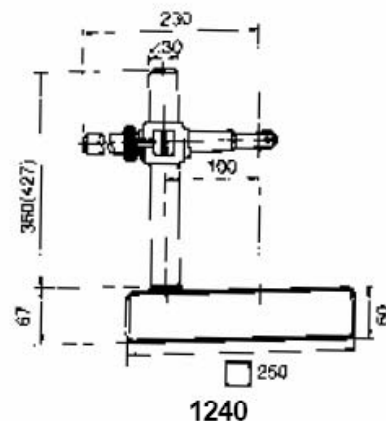
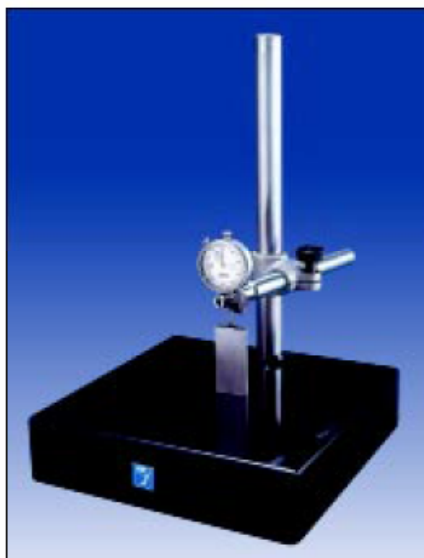

For code No. 1250

Clamping stem diameter : 8 mm

Maxi working height : 300 mm

Fine adjusting range : ENTIRE STROKE

Mass Kg : 18

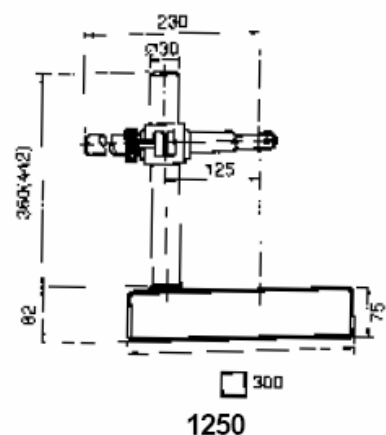

Universal Measuring Block

For checking concentricity, parallelism, axial run-out, taper angle and taper form. Built-in sine rollers allow quick and easy taper angle and taper form measurements in conjunction with gauge blocks. It may also be used for layout work, in conjunction with indicator stands and surface plates.

Removable centres, extra long parts can be mounted directly on V ways.

Centre distance : 0-200 mm

Height of centres : 75 mm

Centre distance of sine rollers : 300 mm

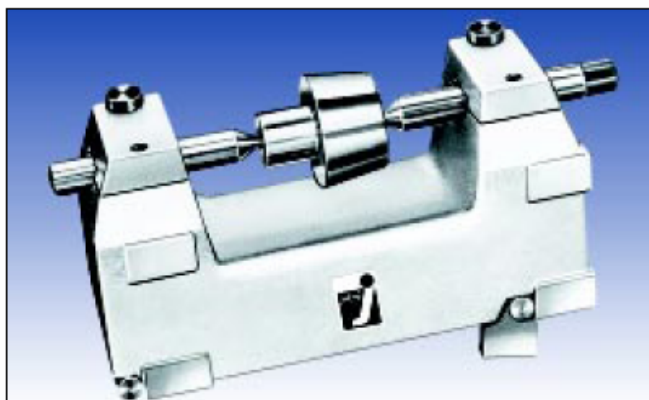

Granite Surface Plates

A crystallin rock, has a fine grained, nonporous texture. It is crystallin throughout and the composition is hard and compact. Granite does not have the soft in-between spaces and has therefore a much higher wear resistance plus a higher degree of flatness accuracy.

The material strength of Surface Plate is three times greater than that of ordinary granite and is super rigid. This Surface Plate has a very low expansion coefficient (5×10^{-6} meter per degree), which makes it least responsive to temperature changes.

100 per cent corrosion-proof and acid resistant. Non-magnetic and easy to clean. No oiling required

which is mandatory on cast iron surface plate and with non-glaring satin finish.

These plates are inspected through Electronic level Processing System of M/s. Wyler, Switzerland, to ensure the accuracy and flatness.

Plates are supplied with a calibration certificate traceable to National Standards showing graphic display of the flatness. The plates are manufactured by high precision lapping method providing 45° chamfering at edges & corners to avoid chip off and cracks.

We can supply MS fabricated stand with leveling screws for the respective plates.

SIZES AVAILABLE				
Length	Width	Thickness	Accuracy as per IS-7327-1991 Grade '0'	Approx. Weight in Kgs.
400 mm	400 mm	60 mm	4.5 um	30
630 mm	400 mm	80 mm	5.0 um	65
630 mm	630 mm	80 mm	5.0 um	100
1000 mm	630 mm	150 mm	6.0 um	295
1000 mm	1000 mm	150 mm	7.0 um	470
1600 mm	1000 mm	200 mm	8.0 um	1000
2000 mm	1000 mm	200 mm	9.5 um	1300

Different sizes are available on request.

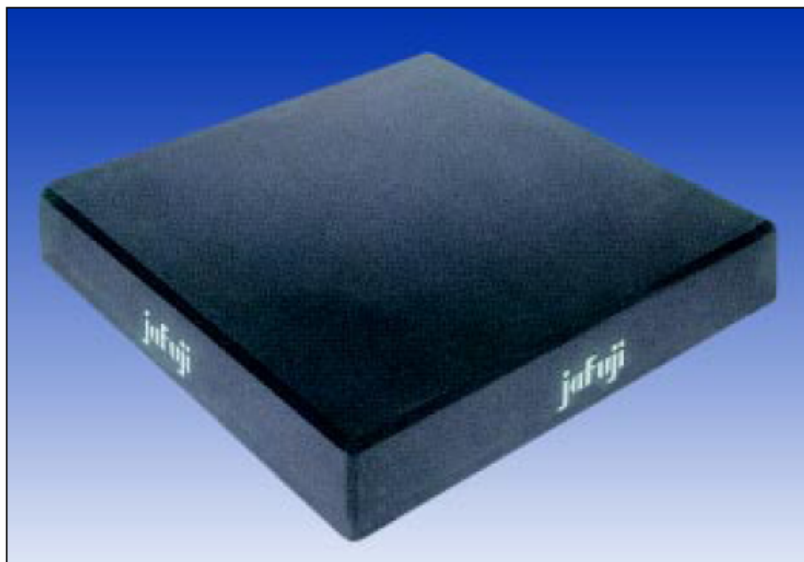

Surface grid (wyler)/philips/ISO 1101

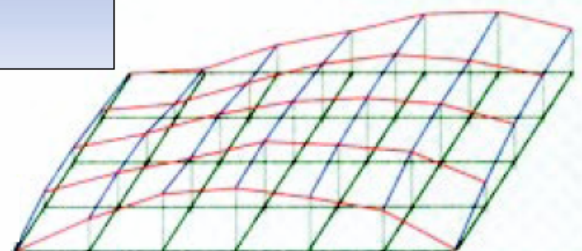

Heavy Duty Highprecision Bench Centre

Surface table and centre heads are made from closed grained iron castings, seasoned, stress relieved and finished on the working face and reference side edge of the table by hand scrapping to meet with the required accuracy's as per ISI Standards.

The centre stock spindle bearings are smooth lapped to ensure accuracy of the spindle height and relationship to reference side edge. The centres are hardened high carbon steel accurately ground on the diameter and conical point.

One centre is spring loaded to accommodate small variations in component length. Tee slot at 45° angle on the surface table and tee bolt through hole at the base of the centre stocks to ensure firm engagement with the reference side edge of the table. Each centre stock can be locked in any position along the tee slot by means of knurled hand knobs.

- Code No. 3010



- Code No. 3030



Code No.	Admit Between Centre	Height of Centre	Morse Taper	Mass Kg.
3010	300 mm	125 mm	MT-3	48
3020	500 mm	125 mm	MT-3	76
3030	500 mm	160 mm	MT-3	105
3040	500 mm	200 mm	MT-3	107
3050	750 mm	160 mm	MT-3	131
3060	750 mm	200 mm	MT-3	137
3070	1000 mm	160 mm	MT-3	138
3080	1000 mm	200 mm	MT-3	142
3090	1250 mm	160 mm	MT-3	200
3100	1250 mm	200 mm	MT-3	202
3110	1500 mm	160 mm	MT-3	204
3120	1500 mm	200 mm	MT-3	206
3130	1500 mm	250 mm	MT-3	211

Casting : Grade 20 of IS 210-1962 with minimum hardness of 180 HB.

Centres : Quality steel of hardness of 750 HV.

Co-ordinated clamping : Fine functional casting. Pre-loaded spring with length adjustment by a micrometric knob seasoned castings. Spring loaded centre on one side.

Hardened V Blocks

The V-Blocks have means of the clamp so that the work can be held tight in the block. The accuracy of parallelism of the 'V' with the bottom, its squareness to the two end faces and the maximum permissible variation in height between two V-blocks in a pair, is within +/- 3 microns.

All Hardened V Blocks are supplied along with calibration certificate traceable to national standard.

Specification:

Model	Clamping Range	Size
JV401	5-30 mm	50 x 40 x 40 mm
JV402	6-50 mm	80 x 63 x 63 mm
JV403	6-70 mm	100 x 80 x 80 mm



V Block Hardened (with clamp)

Hardened and ground on all working surfaces to an accuracy within 0.005 mm

Size : 70x50x60 mm (2.3/4" x 2" x 2.3/8")
Capacity : 50 mm dia (2")

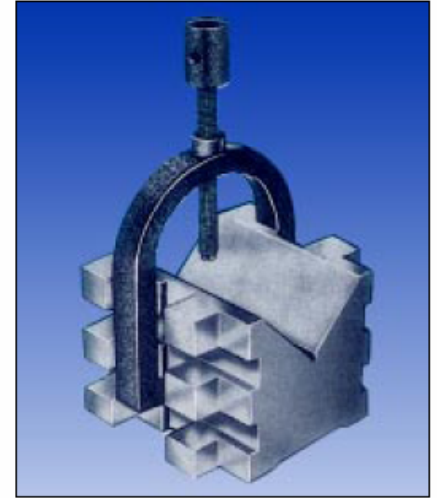

Magnetic V Blocks

It has total 3 magnetic surfaces i.e., the top and bottom each with 90 degree V angle and the end surface is opposite to the switch. All the 3 magnetic surface are accurately ground and care has been taken as such to be used in dry as well as wet machining operations.

From quality aspect the accuracy for flatness, parallelism and squareness is within 5 microns. All Jafuji Magnetic V blocks are supplied along with calibration certificate traceable to national standards.

Specification:

Model	Product	Size (mm)	Pull Kg.
JMV205H	6" Hardened	150x100x75	125
JMV205S	6" Standard	150x100x75	125
JMV201H	4" Hardened	100x95x70	100
JMV201S	4" Standard	100x95x70	100
JMV203H	3" Hardened	75x75x56	75
JMV203S	3" Standard	75x75x56	75

The permanent magnet is housed in such a way that all the three magnetic surfaces are activated simultaneously during 'ON' position of the knob. The High power magnetized surfaces hold any ferrous surface.



Dial Calibration Tester

This versatile instrument for periodic calibration of Plunger type, Black Plunger type, Lever type dial gauges and Bore Gauges. It is supplied both in imperial and metric system. **Electronic also available.**

Models available :

Model 1.

Metric : Range - 0-25
(L. C. : 0.001 mm)

Imperial : Range - 0-1"
(L. C. : 0.001 ")



Shore Hardness Tester

Shore tester provide a fast and easy to read method of testing hardness on rubber, plastics, leather and other soft materials. Features include fast and easy reading portable enough to be easily handled or mounted on a stand (also available). The hardness tester are available in either Shore A or Shore D and supplied with a range/reference

block and manufactured in accordance with specification DIN 53 505, ASTM D2240, IBO R/S68.

Technical data :

Graduation - 1-No.

Minimum area for measurement - 18 mm

Dimension - 110x65x30 mm

Packing - Wooden box.



DIGI-CAL Stand

A versatile stand with swiveling clamp device for holding calipers. It is specially designed for use with both digital and dial calipers of all brands. The stand is helpful particularly when measurement of small components is required.

